

SERVICE BULLETIN

IPGM3 and IPGM4 Cables Coming out of Pulleys

Applies to: 9-IPGM3 + 9-IPGM4

Enhanced Images: Pictures can be zoomed in to any level for detail. Use the standard zoom tools for your platform to zoom in.

On some IPGM3 and IPGM4 Glute Press units, an issue was identified where the cables may jump or come out of the pulleys. Kit 731-9448-KT was developed to resolve this issue.

Required Tools:

- 4mm Allen Key
- 5mm Allen Key
- Ratchet Wrench
- 13mm Socket
- 16mm Socket
- 13mm Open-Ended Wrench
- 16mm Open-Ended Wrench

Required Parts:

- 731-9448-KT "KIT, CABLE, RETROFIT, IPGM5"

1. Use a 5mm allen key to remove the two (2) screws securing the inner top shroud to the weight tower frame, then remove the shroud.

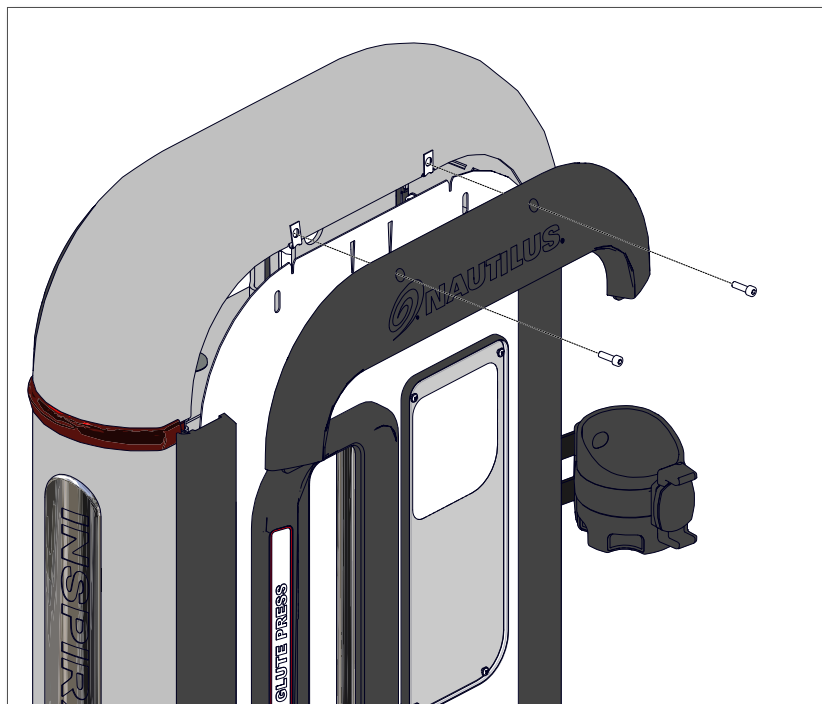

Fig. 1

SERVICE BULLETIN

2. Lift the inner shroud assembly up and out to remove the inner shroud.

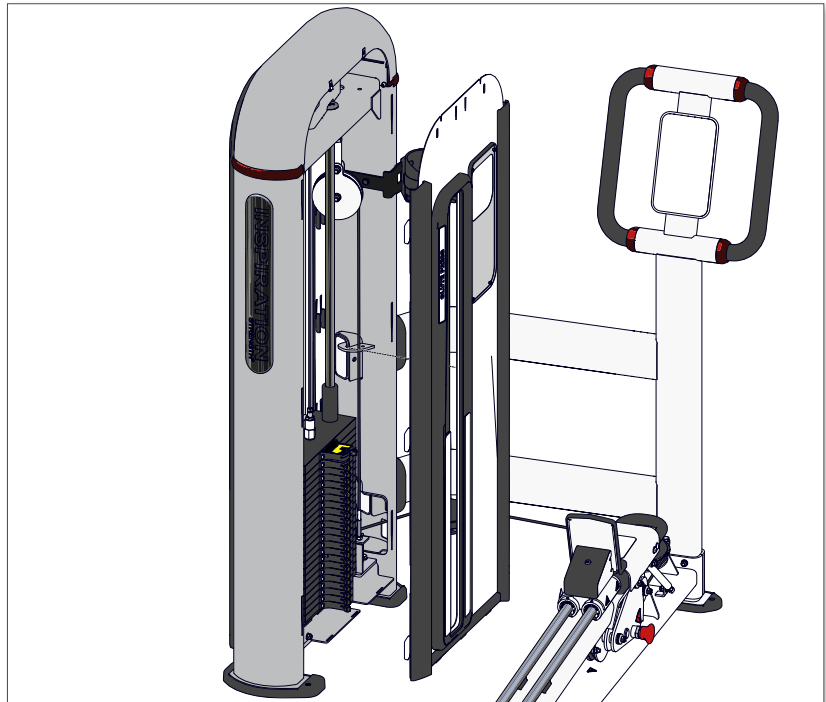

Fig. 2

3. Use a 13mm open-ended wrench to loosen the main cable lock nut, then remove the nut from the bottom of the cable end and disconnect the cable end from the frame.

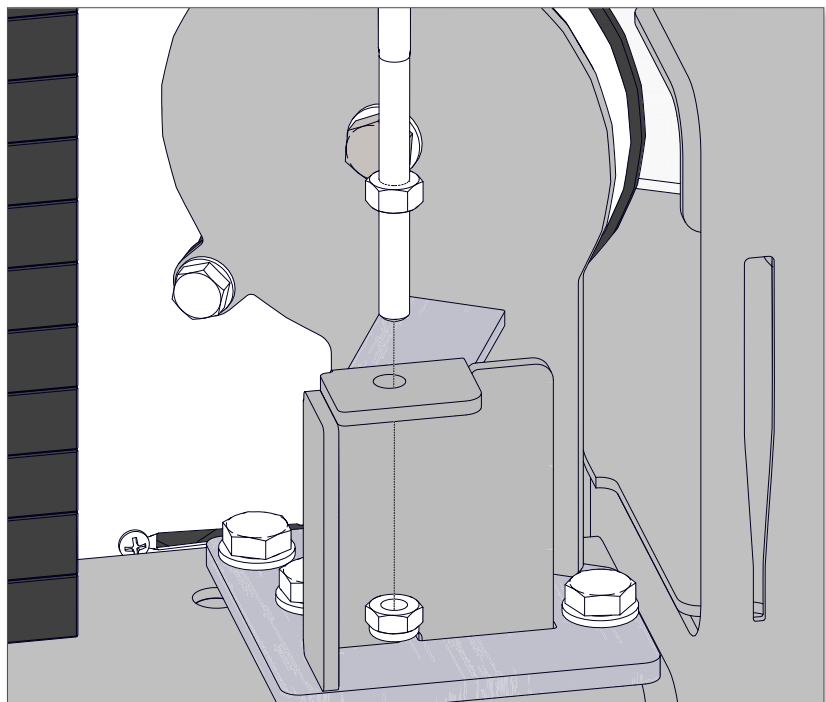

Fig. 3

SERVICE BULLETIN

4. Pull the cable end through the floating pulley.

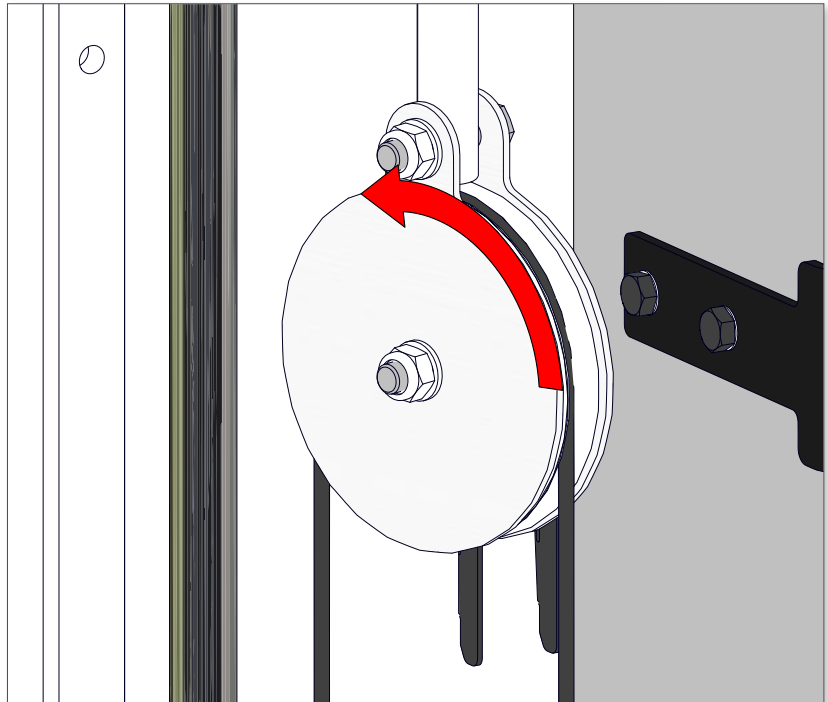

Fig. 4

5. Use an 18mm open-ended wrench to loosen the floating pulley cable end lock nut, then remove the cable end from the top plate.

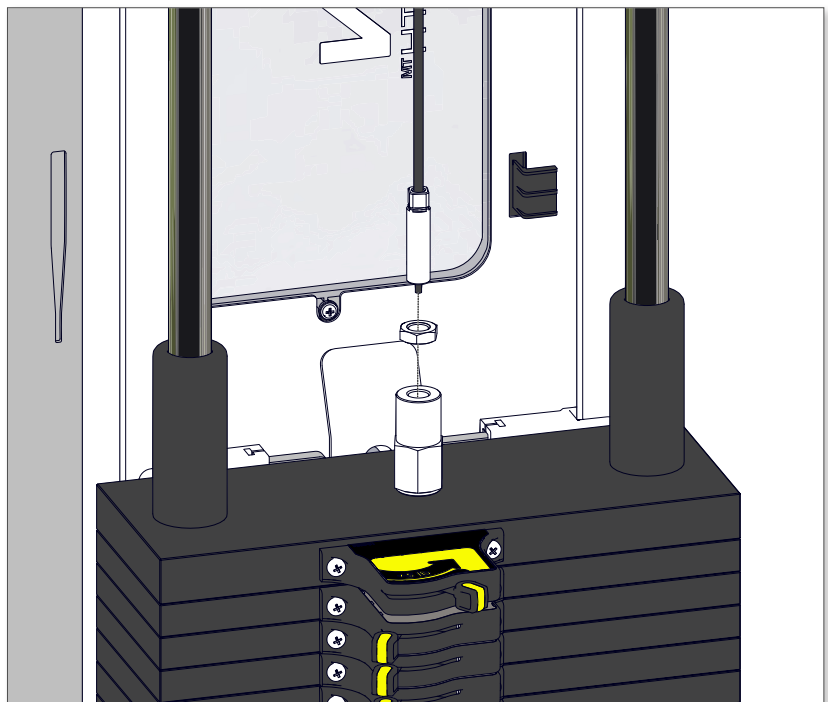

Fig. 5

SERVICE BULLETIN

6. Pull the floating pulley cable end through the pulleys at the top of the weight stack frame, then remove and discard the old floating pulley assembly.

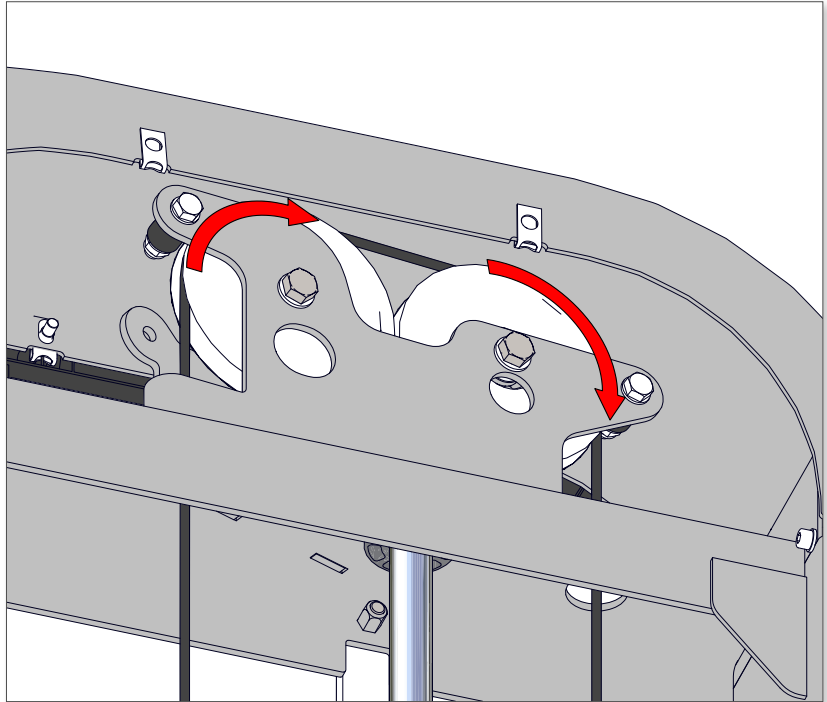

Fig. 6

7. Use a 4mm allen key to remove the two (2) screws securing the main cable mount plate to the foot sled, then remove the plate and disconnect the cable ball end from the sled.

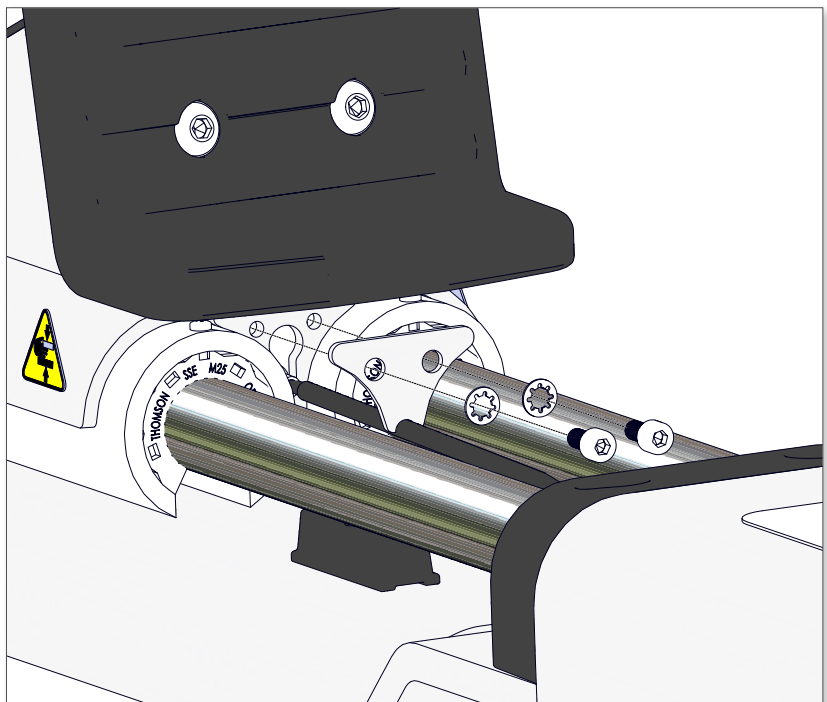

Fig. 7

SERVICE BULLETIN

- 8. Pull the cable ball end through the foot sled pulleys.

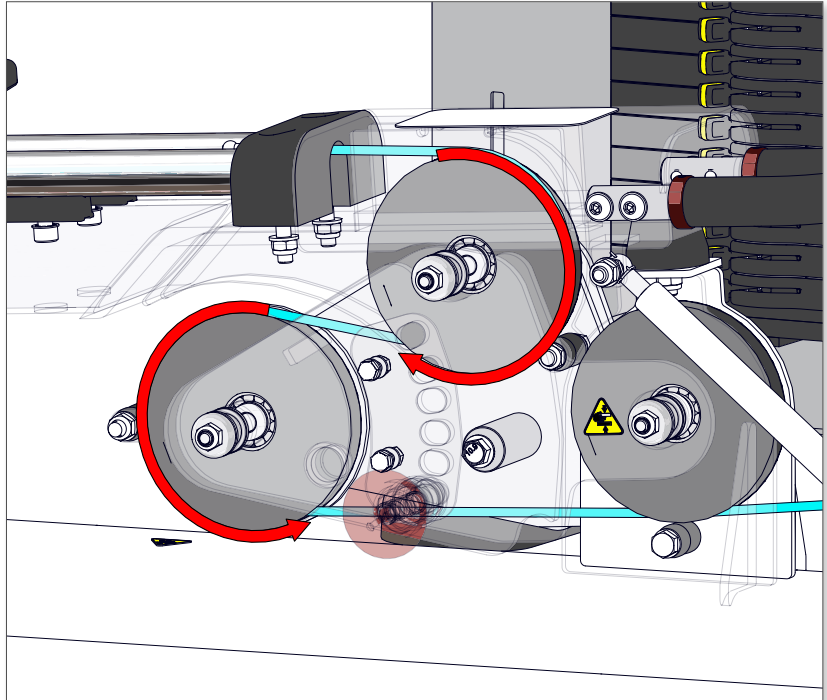

Fig. 8

- 9. Pull the cable ball end through the frame pulleys.

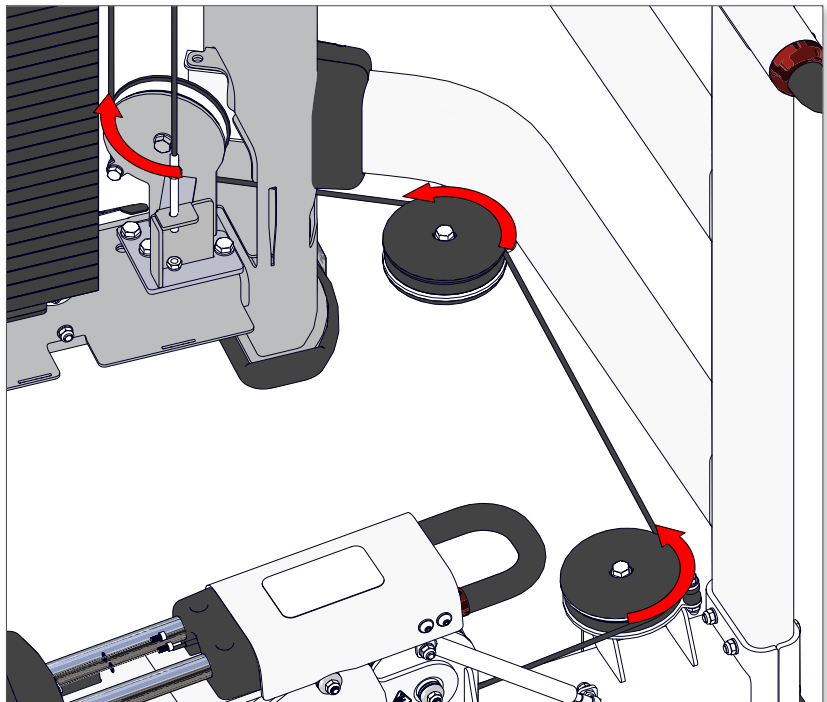

Fig. 9

SERVICE BULLETIN

10. Use a 16mm open-ended wrench, and a ratchet wrench with a 16mm socket to remove the central hardware from the horizontal pulley located directly in front of the sled. Keep this hardware.
11. Use a 13mm open-ended wrench, and a ratchet wrench with a 13mm socket to remove the cable keeper hardware from the pulley. Discard the hardware and the pulley plate.

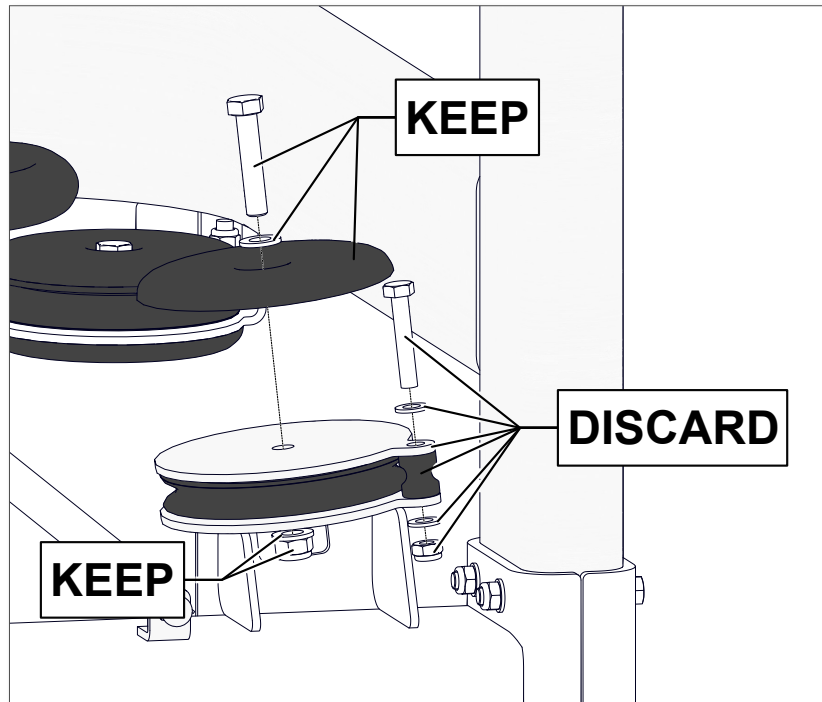

Fig. 10

12. Use a 13mm open-ended wrench, and a ratchet wrench with a 13mm socket to install the double-keeper pulley plate from the kit (731-9448-KT) using the keeper hardware included with the kit.
13. Use the tools and central hardware from Step 10 to install the pulley central hardware.

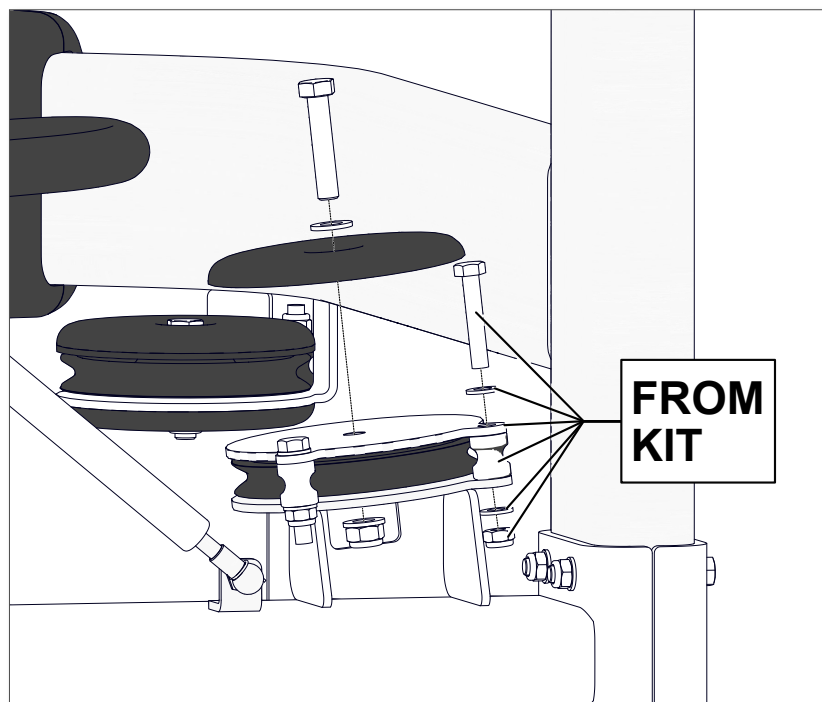

Fig. 11

SERVICE BULLETIN

- 14.** Use a 13mm open-ended wrench, and a ratchet wrench with a 13mm socket to remove the hardware securing the cable keeper to the pulley on the underside of the sled assembly.

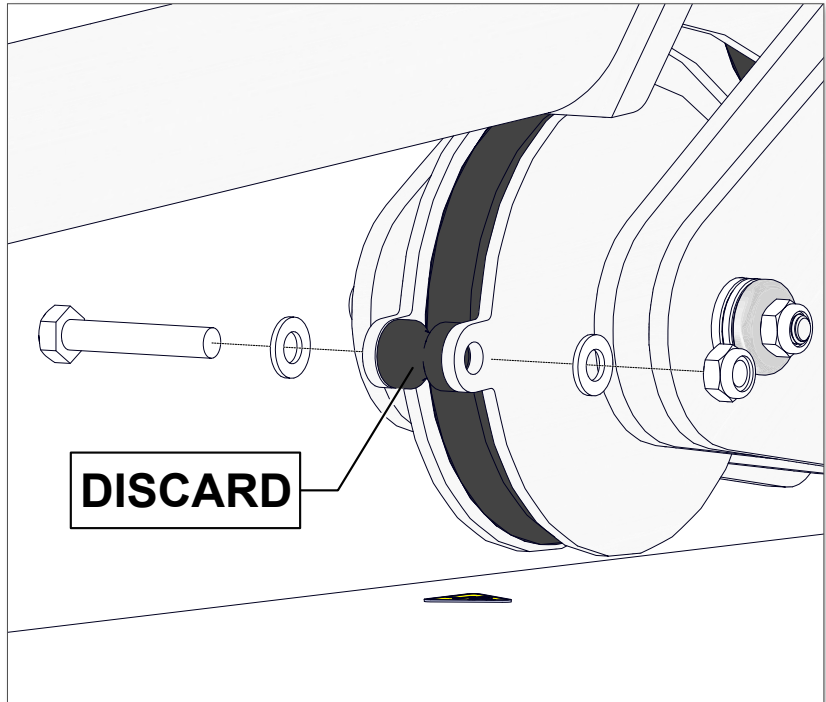

Fig. 12

- 15.** Use the tools and hardware from Step 14 to install the cable keeper from the kit.

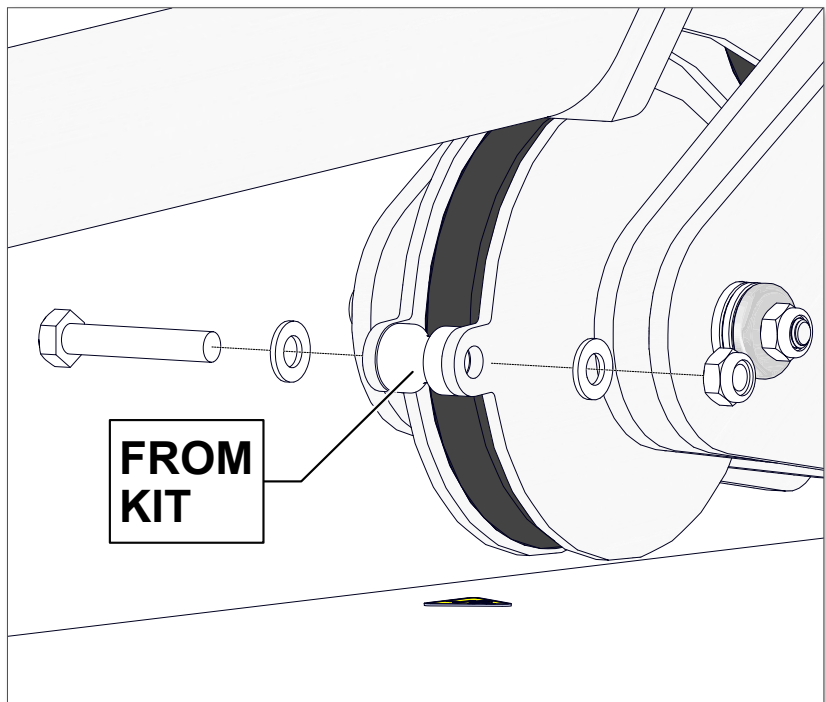

Fig. 13

SERVICE BULLETIN

16. Repeat Steps 14+15 for the remaining three pulley keepers.
17. Follow Steps 9-1 to install the new main cable and floating pulley/ cable assembly, and reinstall the inner shroud.

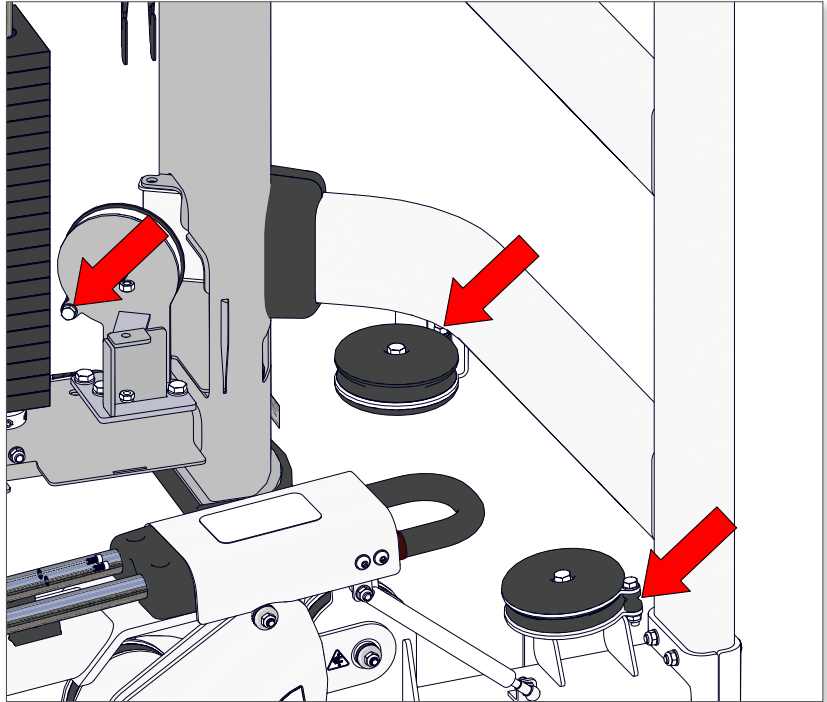

Fig. 14